

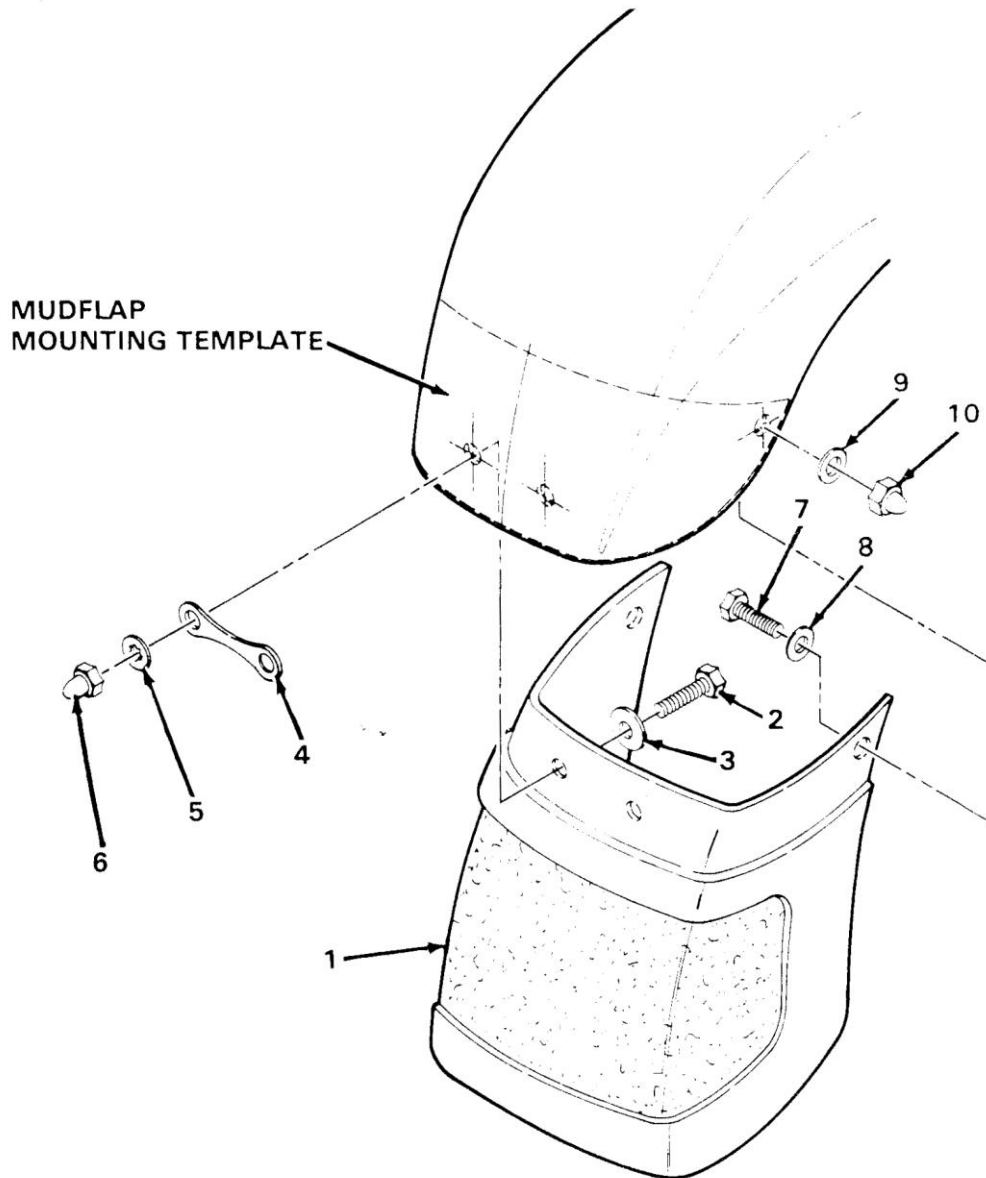

**INSTALLATION INSTRUCTIONS FOR
Part 733-286
GL1200 FRONT FENDER EXTENSION**

Read instructions thoroughly before installation. Drilling required.



TEMPLATE

Part 733-268

Center on Fender

Drill
3/16"
Hole

Drill
9/32"
Hole

Align with Bottom
of Fender